

Thank you very much for purchasing CLEANSUI. Read these instructions carefully before use. A guarantee card is included with this product, and this must be stored for future reference.

Instruction Manual Contents

- | | |
|---|---|
| 1. Checking All Accessories | 10. Installations |
| 2. Safety Precautions | 11. Understanding and Using the Digital Check Monitor |
| 3. Precautions During Use | 12. Operating the Flat Lever |
| 4. Faucets to which CLEANSUI cannot be attached | 13. Replacement of Cartridge |
| 5. Names of Parts | 14. Maintenance |
| 6. Inserting/Replacing the Battery | 15. Troubleshooting |
| 7. Attaching/Replacing Cartridge | 16. Specifications |
| 8. Reset | 17. After-Sale Service |
| 9. Selecting the Attachment Accessory | |

1. Checking All Accessories

Check to ascertain that all of the following items are included in the package when it is first opened.

- ① Main unit (Complete with 1 cartridge)
- ② One battery (CR2032)
- ③ Attachment set
- ④ Instruction manual
- ⑤ Cartridge replacement reminder sticker

● Attachment Set







Contact your dealer immediately in the event of missing accessories or damage.

2. Safety Precautions



For your safety, please read the precautions carefully before installation or usage. Disregard or improper installation/usage may cause damages or results in dire consequences.

●The following warning symbols are used in this manual.

 Warning	<p>Indicates instructions that may result in death or injury if ignored.</p>	 Warning	<p>Never ignore this instruction. Failure to observe may result in injury or damage to surrounding assets.</p>
 Forbidden	<p>Indicates the actions that are prohibited for safety precautions.</p>	 No Dismantling	 Instruction



Warning

 Instruction	<p>Make sure that batteries are stored out of reach of infants.</p> <ul style="list-style-type: none"> • Contact your doctor immediately in the event of swallowing the battery. Failure to observe this may result in the liquid contained in the battery contaminating the stomach. 	
---	---	---

There is a risk-leakage, overheating, bursting, and fire outbreak.

 Forbidden	<ul style="list-style-type: none"> ● Do not use any battery other than the specified one (CR2032) 	<ul style="list-style-type: none"> ● Do not leave or store the battery in a location subject to high temperatures (in direct sunlight or in a vehicle standing out in the sunlight.) • Failure to observe this may result in damage to the insulation and internal mechanism. Failure to observe this may result in diminished battery performance and life expectancy.
	<ul style="list-style-type: none"> ● Make sure the battery is inserted with the + and - poles in the correct position. • There is a risk-leakage, overheating, bursting, and fire outbreak. Refer to [6.Inserting/Replacing the Battery] for more details. 	<ul style="list-style-type: none"> ● Do not allow the battery to become wet. • Failure to observe this may result in the battery overheating. Refer to [6. Inserting/Replacing the Battery] for more details.
	<ul style="list-style-type: none"> ● Do not heat the battery. • Failure to observe this may result in damage to the insulation and internal mechanism. • Do not put the battery in a microwave or oven. 	<ul style="list-style-type: none"> ● Do not subject the battery to powerful impact or otherwise alter its shape. • Failure to observe this may result in damage to the insulation and internal mechanism.
	<ul style="list-style-type: none"> ● Do not recharge the battery used with CLEANSUI. • Failure to observe this may result in damage to the insulation and internal mechanism. 	<ul style="list-style-type: none"> ● Do not dismantle the battery. • Failure to observe this may result in damage to the insulation and internal mechanism.



Avoiding leakage, overheating, bursting, and fire outbreak.



Instruction

- Disconnect CLEANSUI from the faucet when replacing the battery, and perform the replacement in a dry location.
- Failure to observe this may result in overheating if the battery comes into contact with moisture.
- Insulate the terminal poles with tape or a similar material when storing or disposing of the battery.
- The battery may short circuit if it comes into contact with other batteries or other metal objects (necklaces, hairpins, etc.)

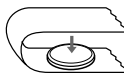

In the event of the battery leaking or emitting a foul odor.



Instruction

- In the event of the battery leaking or emitting a foul odor, move it away from the source of the heat immediately.
- Note that there is a possibility of the liquid leaking from the battery igniting.

In the event of coming into direct contact with the liquid leaking from the battery.



Instruction

- If the liquid enters the eyes, do not rub them but rinse them with large volumes of clean water and immediately consult your doctor.
- Failure to observe this may result in the loss of sight or other damage to the eyesight.
- If the liquid comes into contact with bare skin or clothes, rinse the affected area with large volumes of clean water.
- Failure to observe this may result in skin damage.



Warning



Instruction

- Always use tap water that meet the standard requirements set for drinking water.
- Failure to observe this may result in illness.

Using Filtered water



Instruction

- Run the filtered water for at least 10 seconds before using your CLEANSUI for the first time of usage every day.
- How to maintain best hygiene care to avoid spread of bacteria, etc.
- Run the filtered water for at least 1 minute to discharge accumulated water when CLEANSUI has not been used for 2 or more days.
- How to maintain best hygiene care to avoid spread of bacteria, etc.
- Best to use/drink instant filtered water as soon as possible, fresh water is better than stale water kept for some time. If you like to store filtered water, we recommend storage in a closed lid container in a refrigerator.
- There is a risk-bacteria, other impurities from the air etc. may settled in stale water, as residual chlorine is removed.



Forbidden



- Do not touch the filtered water outlet with hands.
- How to maintain best hygiene care to avoid spread of bacteria, etc.
- Do not use filtered water for breeding fishes, etc.
- There is a risk- the fish dying if residual chlorine is not sufficient removed or if the temperature of the water is inappropriate.



The Risk of the Filtering Abnormalities, Water leakage and Damages

 Instruction	<ul style="list-style-type: none"> ● Always ensure that the main unit and cartridge are used in combination as a set. • Failure to observe this may result in damage or water leakage. 	<ul style="list-style-type: none"> ● Turn the tap (ON/OFF) very slowly. • Failure to observe this may result in damage or water leakage. 	<ul style="list-style-type: none"> ● Please replace the cartridge when the flow rate of filtered water drops. • Failure to observe this may result in damage or water leakage.
	<ul style="list-style-type: none"> ● Please reduce tap water flow speed especially in areas with very high water pressure. • The phrase Over flow rate may be displayed on the Digital Check Monitor when installed in location with high water pressure. In this event, reduce the water volume until the display is cleared. • There is a risk-water filtration performance cannot be fully exploited when used with fast water flows. This may also result in damage or water leakage. Use CLEANSUI with a water pressure range of between 0.07MPa and 0.35MPa. 		

The Risk of the Filtering Abnormalities, Water leakage and Damages

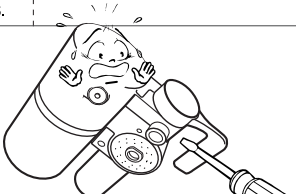
 Instruction	<ul style="list-style-type: none"> ● Do not allow CLEANSUI to freeze  <ul style="list-style-type: none"> • Failure to observe this may result in damage or water leakage. 	<ul style="list-style-type: none"> ● Do not run water with a temperature of 35 degrees Celsius or higher through to the cartridge/purifier mode. • Failure to observe this may reduce the effectiveness of the activated carbon and result in absorbed properties (odors, etc.) which may affect the filtered water. 	<ul style="list-style-type: none"> ● Do not run water with a temperature of 60 degrees Celsius or higher through to the straight tap water or spray tap water mode. • Failure to observe this may result in damage or water leakage.
	<ul style="list-style-type: none"> ● Do not obstruct the filtered water outlet or attach other equipment to it. • Failure to observe this may result in damage or water leakage. 	<ul style="list-style-type: none"> ● Do not use detergent or alcohol, etc., to clean the product. • Failure to observe this may result in cracking, scratching, discoloring or malformation. See [14. Maintenance] for further details. 	<ul style="list-style-type: none"> ● Do not submerge CLEANSUI in water during maintenance. • Failure to observe this may result in damage.
Instruction  No Dismantling	<ul style="list-style-type: none"> ● Do not dismantle the unit or the cartridge. • See [15. Troubleshooting] if you think something is wrong. 		

Installing CLEANSUI

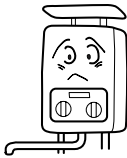
 Forbidden	<ul style="list-style-type: none"> ● Do not connect flash stopcock-type water heaters or stopcock-type electric water heaters. • Failure to observe this may result in damage or water leakage. 	<ul style="list-style-type: none"> ● Do not install in locations that are close to naked flames or high temperatures. • Heat may result in warping, damage and water leakage.
--	--	--

3. Precautions During Use

- **These are incompatible faucets to which CLEANSUI cannot be attached.**
 - See [4. Faucets to which CLEANSUI cannot be attached] for further details.
- **Precautions when attaching CLEANSUI to mixed-water faucets.**
 - There are rare incidents when the gas frames on the water heater will not ignite properly.
 - There are incidents when the safety valve on the water heater operates if it is not equipped with a non-return valve.
 - There are incidents when the temperature of the spray water is not stable in locations with low water pressure and when storage heaters are in use.
- **Precautions when passing water through CLEANSUI immediately after commencing usage for the first time and after cartridge replacement.**
 - Turn the faucet on at low volume with the flat lever in the shower position, and then move it slowly to the filtered water position.
 - Gradually increase the water volume while checking for leakage at all parts of CLEANSUI.
(Incorrect attachment to the faucet and incorrect cartridge attachment may result in damage and leakage.)
※ Note that it may take several seconds for the filtered water to flow while the air is being purged from the cartridge when using CLEANSUI for the first time. This is not a defect.
- **The lifespan/replacement period of a cartridge will differ in accordance to the volume of filtered water, tap water quality, water pressure etc.**
 - See [13. Replacement of Cartridge] for further details.
- **It is not advisable use hot-spring water, well water or any other water that contains large amounts of impurities.**
- **The working pressure of CLEANSUI is from 0.07 to 0.35MPa.**
- **When the unit has not been used for a long period of time or the tap water has a red tinge (turbidity,) allow tap water to flow through straight or spray tap water mode for some time before switching to instant filtered water mode.**
- **The filters/purifier cannot remove saline (seawater) or metallic ions except lead present in water, although it can remove heavy metal particles/turbidity. It is also not capable of converting hard water to soft water.**
- **Only use the filter water for drinking and cooking.**
- **Do not remove the batteries at any time other than when replacing them.**
 - See [6. Inserting/Replacing the Battery] for further details.
- **To ensure accurate measurements, always reset the unit when using the system for the first time, after replacing the cartridge, and after replacing the cartridge and batteries at the same time.**
 - See [8. Reset] for further details.
- **The [Cartridge life display] displays the total amount of water that has been filtered.**
 - See [11. Understanding and Using the Digital Check Monitor] for further details.
 - The total volume of water that passes through the cartridge is subject to miscalculation in accordance with water pressure and water temperature.

4. Faucets to which CLEANSUI cannot be attached

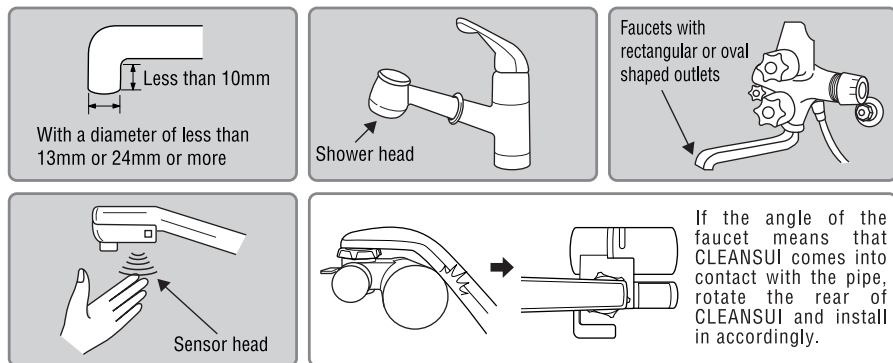

Optional special attachment accessories (sold separately on request) may fit faucet when accessories supplied do not fit. Contact your dealer.

5. Names of Parts

● Cross-section of Unit

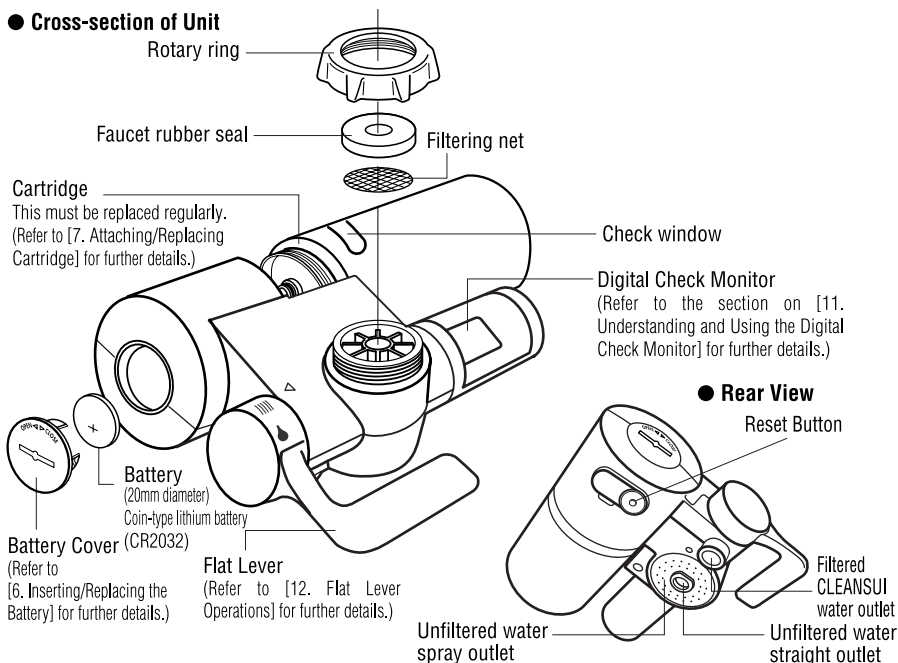

6. Inserting / Replacing the Battery

※ Always use the CR2032 coin-type lithium battery available from your dealer.

● Disconnect CLEANSUI from the faucet when replacing the battery, and perform the replacement in a dry location.

(1) Remove the cover by use of a coin. Take out the old battery.

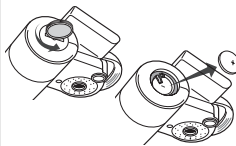

(2) Embed a new battery in the purifier.

Make sure that the battery direction is correct.

Coin-type lithium battery
CR2032 (3 V)



(3) Put the cover back.

Align the dot-mark on the cover with the line on the purifier.

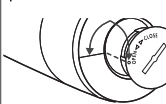

(4) Screw the cover by use of a coin.

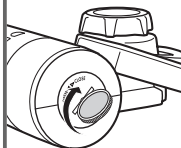

7. Attaching / Replacing Cartridge

Observe the following when attaching cartridges. Reverse the procedure when removing at replacement.

- Ensure water supply is completely turned off when removing or attaching cartridges.
 - If the cartridge is not tightened sufficiently or is tightened too tightly, it may result in water leakage or damage.
- Write the date of cartridge on first day of usage (and at every cartridge replacement) on sticker provided, stick the sticker on the cartridge to provide a reminder for next replacement.
- Press the [Reset] button when using CLEANSUI for the first time, after replacing the cartridge, and after simultaneously replacing the cartridge and battery. (Refer to [8. Reset] for further details.)
- A cartridge is already set in place (ready for use) at purchase.

Set the cartridge
into CLEANSUI.

Rotate the cartridge clockwise until snug
(with the check window facing upwards.)

8. Reset

Press the [Reset] button.

The system has been reset when [Cleansui] is displayed in the LCD window.

[Digital Check Monitor with
CLEANSUI has been reset.]

Cleansui

- ※ The [Reset] button is located on the rear of CLEANSUI.
- ※ Press the button with your finger.
- ※ Never use sharp objects (ballpoint pens, etc.) to press the button.
 - Failure to observe this may result in damage to the [Reset] button.
- ※ Press the [Reset] button with the water flow halted.
 - CLEANSUI cannot be reset if the water is filtered.
- ※ Press the [Reset] button when using CLEANSUI for the first time, after replacing the cartridge, and after simultaneously replacing the cartridge and battery.
 - This procedure measures the correct amount of water to be allowed to pass through the new cartridge.



9. Selecting the Attachment Accessory

- Check your faucet type. Look closely at the edge/tip-that will tell you which attachment will be best fit. Use/fix the best fit attachment accessory.
 - Store unused attachment accessory as they may be useful in future if you change your faucet or move to a new home.
- There are faucets to which CLEANSUI cannot be attached.
 - Refer to [4. Faucets to which CLEANSUI cannot be attached] for further details.
- Check to ensure that there are no cracks or burrs on the edge of the faucet.
- Unstable and loose connections with the faucet may result in CLEANSUI leaking or being damaged.

10. Installations

Determine which adopter is needed for your faucet

CL540

Straight edge faucets

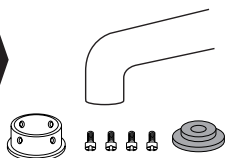

- 1 Insert the rotary ring inside the screw-stopper ring

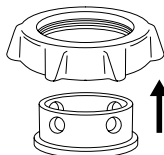

- 2 Temporarily tighten the four screws

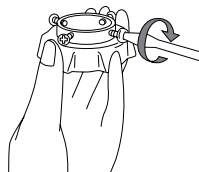

CL521

Outer screw tip faucets

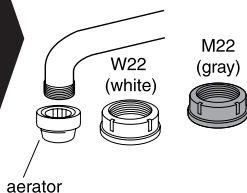

- 1 Remove the aerator on faucet in a clockwise direction. Remove any loose rubber washer that may still be inside the current faucet.

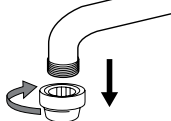

A wrench may be necessary if it is too tight.

- 2 Insert the new rubber washer into the neck.

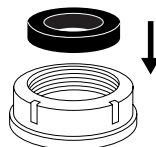

CL531

Inner screw tip faucets

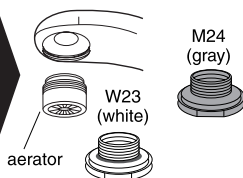

- 1 Remove the aerator on faucet in a clockwise direction. Remove any rubber washer that may still be inside the current faucet.

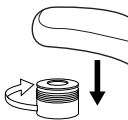

A wrench may be necessary if it is too tight.

- 2 Insert the new rubber washer into the neck.

* When the M24 is to be used.

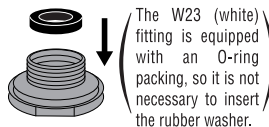

Option

Faucets to which CLEANSUI can be affixed using optional attachment

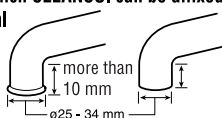

CS002C

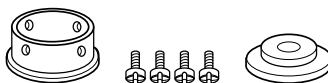

- 3** Insert the rubber washer, turn the rotary ring once on the main unit's ring portion, tighten gently.

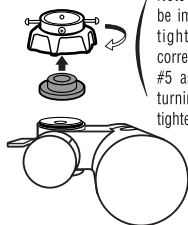

Note that it will be impossible to tighten it correctly in Step #5 as excessive turning prevent tightening.

- 4** Firmly press the unit onto the bottom of the faucet and tighten the screws. Make sure that the faucet is located in the center of the screw stopper ring

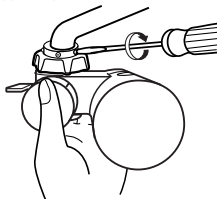

- 5** Tighten the rotary ring tightly to complete the procedure



- 3** Slip the rotary ring into the faucet. In clockwise direction, tighten the attachment with washer intact. Turn the rotary ring so that it is face upward, and then tighten/position to fit nicely onto main unit ring



- 4** Use a coin or something similar (slot into rear indent of accessory) and tighten gently.

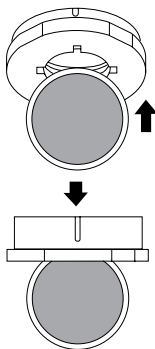

- 5** Set the main unit in place



- Tighten the rotary ring gently but not very tightly to complete the procedure



- 3** Slip the rotary ring into the faucet. In clockwise direction, tighten the attachment with washer intact. Turn the rotary ring so that it is face upward, and then tighten/position to fit nicely onto main unit ring

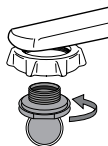

11. Understanding and Using the Digital Check Monitor

The Digital Check Monitor will light up only when water is being passed through in the [Filtered water] mode (it will not light up if the water volume is too small.)

① Cartridge life display

Display cartridge life in numerics with replacement indicator/reminder.

- The value is counted down in accordance with the total amount of filtered water that passes through CLEANSUI.

[Prepare new cartridge]

When the remaining capacity of [50L]

the cartridge drops below 50L, the screen will scroll between

the remaining capacity,

[Prepare], [new] and [cartridge].

[Change cartridge]

Replace the cartridge when the remaining capacity reaches [0L].

- The figures displayed for remaining filter capacity are the stipulated total filtration capacity minus the total volume of filtered water that has been passed through the cartridge. The remaining filtration capacity is not an indicator of the hollow fiber membrane filter being clogged, of deteriorated water flow rate, or of odors or taste.

[900L at the start of usage.]



[899L]

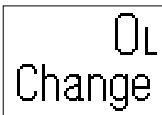
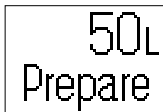

[0L (Litres)]



② Flow rate monitor

The phrase [Over flow rate] will be displayed if the water flow rate is too strong during water filtering. The animated wave shape display will also speed up in accordance with the amount of water flowing. Reduce the water volume in this event. The display will return to its original setting when the water flow is suitable for water filtering.

- There are cases in which [Over flow rate] will be displayed if CLEANSUI is installed in locations with high water pressure. Reduce the water volume in this event. There is also a chance that water filtering performance cannot be fully exploited when installed in locations with high water pressure. This may also result in damage or water leakage. Use CLEANSUI with a water pressure range of between 0.07MPa and 0.35MPa.



③ Battery life display

When the battery is nearing the end of its life span, the screen will scroll between the remaining capacity, [Battery], [life] and [indicator].

[Battery life indicator]

(※Coin-type lithium battery (CR2032))

[Change battery]

The phrase [Change battery] will be displayed on the entire screen when the battery runs out of requires replacement. Replace the battery in this event.

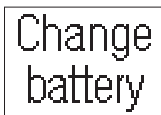

12. Operating the Flat lever

Run water on and off from the faucet, use the lever on the unit to switch between unfiltered water/straight, unfiltered water/spray or filtered water. See the following illustrations for further details.

※ The Digital Check Monitor lights up only when filtered water flows.

● Unfiltered Water (straight) I

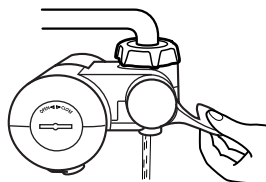

Set the lever to [I].

● Unfiltered Water (spray) IIII

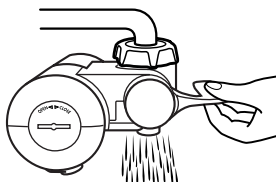

Set the lever to [IIII].

● Filtered water

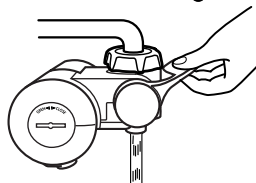

Set the lever to [●].

Points to Note

- If the unit is not used for a long period of time, run the tap water for a few moments before using it.
 - This is to prolong ensure the long life of the cartridge.
- Stick the sticker with date of first usage in a visible position.

- The filtered water is recommended for drinking water and cooking.
- The lifespan of the cartridge will be greatly reduced if it is used for washing dishes, etc.



- Bubbles may be present in filtered water when used first time, this is not a defect. It denotes that presence of air in the cartridge.

13. Replacement of Cartridge

CLEANSUI unique state-of-art purification system remove unhealthy substances but leave healthy minerals intact to give you clean natural delicious water straight from your tap.

- Unique features of Model CSP601E with original cartridge HGC9SE

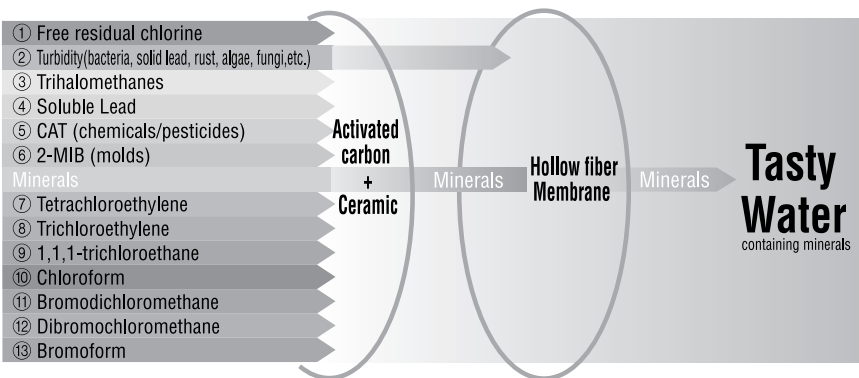

- **Replace the cartridge if the [Cartridge life display] on the Digital Check Monitor shows [0L (Litres)] and the phrase [Change cartridge] is displayed.**

→ The total volume of water that has passed through the cartridge has exceeded 900L. Replace the cartridge.

Prepare a new cartridge when the [Cartridge life display] gets close to [0L (Litres)].

• **Refer to [11. Understanding and Using the Digital Check Monitor] for further details.**

- The [Cartridge life display] on the Digital Check Monitor is used to display figures based on the total amount of filtered water that has passed through the cartridge. It does not tell cartridge replacement based on the hollow fiber membrane filter being clogged, deteriorated water flow rate, or odors or taste.
- Note that the total volume of filtered water that passes through the cartridge is subject to miscalculation in accordance with water pressure and water temperature.

Recommendation: Please replace the cartridge when you notice the following.

- **When the odor of residual chlorine or other odors are obvious.**
→ The performance of the activated carbon have deteriorated.
- **When the flow rate/volume of filtered water is substantially lower than usual speed e.g. it takes 15 or more seconds to fill a cup.**
→ The hollow fiber membrane filters are clogged. The flow rate will not increase even when the faucet is switch on maximum.
 - There is a possibility that cracks have appeared (when it is badly clogged), so it is necessary to replace the cartridge.

When the check window show that the cartridge is badly stained/clogged.

- **The level and color of stains will vary according to the source water quality e.g. in industrial environments, the stain appear black or rust, while in highly residential areas-stains appear in varying shades of beige. The new cartridge is almost snow white in color.**
 - There are incidents when volume of water decrease even though stains are not conspicuous, and incidents when volume of water do not decrease even though heavy stains are obvious.
- **If the flow rate of filtered water generated does not decrease despite the cartridge being stained, it means that the hollow fiber membrane filter is not clogged.**
- **Trapped substances - obvious through check window will not affect the filtered water, as it will not be mixed, flow is in one direction, not necessary to replace cartridge.**
- **There are incidents when black particles are seen on the check window, these are due to the very fine and high performance purification filters in use, and will not affect the quality of the filtered water, so not necessary to replace cartridge.**

14. Maintenance

1. Rinse CLEANSUI with water (no detergent, etc.) prior to usage.



Forbidden

Do not use detergent, cleaner, thinner, benzene, alcohol, oil or any other agent for cleaning CLEANSUI.

- Failure to observe this may result in cracks, scratches, discoloring or malformation.
- Wipe immediately if any of these substances come into contact with the unit.

The surface of the Digital Check Monitor is easily scratched and should not be rubbed. Do not submerge CLEANSUI in water during maintenance.

- Failure to observe this may result in damage.

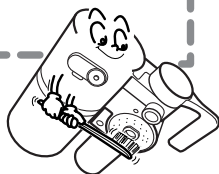

2. The rubber seal is expendable, replace when it is old or worn.

3. Rinse the shower head with water and a sanitary toothbrush, etc.(do not use detergent) to clean it. Set the position of the 3 way diverter dial to tap water saving shower for a few moments after cleaning it.

15. Troubleshooting

Problem	Potential Causes	Recovery
Water leakage at attachment accessory	Had the accessories been attached to the faucet correctly?	Re-attach the unit from the beginning.
	Is the tip of the faucet damaged?	The faucet need to be repaired, or the heat-insulation packing needs to be replaced.
	Is the rubber seal damaged?	Replace the rubber seal.
Low water volume/slow flow from both the tap water and shower head	Is the filtering net stained?	Rinse the shower head with water and a sanitary toothbrush, etc. (do not use detergent) to clean it. Set the position of the 3 way diverter dial to tap water saving shower for a few moments after cleaning it.
Shower head output is not even	Is the shower head stained?	
Low filtered water volume	Could the hollow fiber membrane be clogged. Refer to [13. Replacement of Cartridge] for further details.	Replace the cartridge.
	The water pressure is low	This is not a defect
	The water temperature is low	This is not a defect
Strange taste or odor in filtered water	Is the cartridge lifespan up, is it due for replacement. Refer to [13. Replacement of Cartridge] for further details.	Replace the cartridge.
Bubbles in filtered water when used for the first time	Air is present in the unit.	This is not a defect.
A noise is emitted during water filtering.	This is the noise of the flow rate sensor operating.	This is not a defect.
Nothing is displayed on the Digital Check Monitor during water filtering.	Has a battery been inserted?	Insert a battery.
	Has the battery run out?	Replace the battery.
	Has the battery been inserted upside down?	Insert the battery correctly.
	Is the flow rate too small?	Nothing is displayed on the Digital Check Monitor is the flow rate is too slow. Cartridge replacement is recommended.
CLEANSUI won't be reset.	Is the filtered water in use?	Reset CLEANSUI with the water turned off.

16. Specifications

Product Name	CLEANSUI CSP601E		
Model Number	CSP601E		
Material	ABS		
Filter components	Polyethylene hollow-fibre membrane, Antibacterial activated carbon, Ceramic		
Initial water flow rate	1.6 litres/minute		
Minimum working water pressure	0.07MPa		
Filtration performance ※	Free residual chlorine	900 litres	80% removed
	Turbidity	900 litres	50% filtration flow rate
	Trihalomethanes	900 litres	80% removed
	Chloroform	900 litres	80% removed
	Bromodichloromethane	900 litres	80% removed
	Dibromochloromethane	900 litres	80% removed
	Bromoform	900 litres	80% removed
	Lead	900 litres	80% removed
	CAT (chemicals/pesticides)	900 litres	80% removed
	2-MIB (molds)	900 litres	80% removed
	Tetrachloroethylene	900 litres	80% removed
	Trichloroethylene	900 litres	80% removed
	1,1,1-trichloroethane	900 litres	80% removed
Dimensions	124 (W) × 132 (D) × 79 (H) mm		
Weight	310g, (430g, when filled with water)		

※ Based on results of JIS S 3201 tests.

17. After - Sale Service

● Warranty

CLEANSUI water purifier comes with a warranty. Full details including dealer's name, the date of purchase etc. must be completed accurately and duly return. The validity of the warranty is one year from the date of purchase, subject to terms & conditions listed on Warranty.

● Requested Repairs

1. When repairs are required during the validity period of the warranty, take the product and the warranty card to your dealer.
2. Seek your dealer's advice if repairs are required after warranty lapse. There will be a chargeable repair service fee.
3. Parts for CLEANSUI water purifier (including the cartridges) will be kept in stock and made available for a minimum of five years after the product has been discontinued.